

Preliminary Specification

Customer : _____
C.D Number : _____ KH1909006 _____
Description : _____ 3.4" TFT(800RGB*800) _____
REV : _____ A _____

Acceptance

Solomon Goldentek Display Corp.

**18 Ta-Yeh St., Ta-Fa Industrial Park, Ta-Liao
Hsiang, Kaohsiung Hsien 831, TAIWAN R.O.C**
FAX: 886-7-788-6806~8

Approved by	Checked by		Made by

Item	Specification	Unit
Screen Size	3.4 inches	Diagonal
Display Resolution	800 (H) x 800 (V)	Pixel
Active Area	87.6 (H) x 87.6 (V)	mm(circle)
Outline Dimension	96.6 (H) x 99.0 (V) x 2.42 (D)	mm(circle)
Display Mode	Normally Black mode/ Transmissive	--
Surface Treatment	Glare	--
Pixel Arrangement	R,G,B Vertical Stripe	--
Pixel Size	0.1095 x 0.1095	mm
Display Color	16.7M	--
Viewing Direction	Free	--
Input Interface	MIPI	--
LCM IC	ILI9881C	
Operating temperature	-20~70	°C
Storage temperature	-30~80	°C

Matched Connector: Hirose FH26W-39S-0.3SHW

Pin No.	Symbol	I/O	Function	Remark
1	GND	P	Ground	
2~3	LED+	P	Backlight Anode	
4~5	LED-	P	Backlight Cathode	
6	GND	P	Ground	
7~8	VGL	P	Display -5V	
9	GND	P	Ground	
10~11	VGH	P	Display +5V	
12	GND	P	Ground	
13~14	VDD	P	Power Supply for LCD(1.8V)	
15	GND	P	Ground	
16	DReset	I	Reset	
17	GND	P	Ground	
18	TE	O	Disp tearing effect out	
19	GND	P	Ground	
20~22	NC	-	No connection	
23	GND	P	Ground	
24	MIPI-D2P	I	MIPI data input(+)	
25	NC	-	No connection	
26	MIPI-D2N	I	MIPI data input(-)	
27	GND	P	Ground	
28	MIPI-CLKP	I	MIPI clock input(+)	
29	NC	-	No connection	
30	MIPI-CLKN	I	MIPI clock input(-)	
31	GND	P	Ground	
32	MIPI-D1P	I	MIPI data input(+)	
33	NC	-	No connection	
34	MIPI-D1N	I	MIPI data input(-)	
35	GND	P	Ground	
36	MIPI-D0P	I	MIPI data input(+)	
37	NC	-	No connection	
38	MIPI-D0N	I	MIPI data input(-)	
39	GND	P	Ground	

I: Input, O: Output, P: Power

Item	Symbol	Condition	Min	Type	Max	Unit	Note
Brightness	B		-	(300)	--	cd/m ²	
Response time	Tr+ Tf	$\theta=0^\circ$	--	25	35	ms	
Contrast ratio	CR	At optimized viewing angle	(600)	(800)	--	--	
Luminance Uniformity	ΔL		70	75		%	
Color Chromaticity (CIE 1931)	White	x	$\theta=0^\circ$ Normal Viewing Angle	--	(0.313)	--	BM-7A
		y		--	(0.329)	--	
Viewing Angle	Hor.	θ_R	CR \geq 10	--	80	--	Degree
		θ_L		--	80	--	
	Ver.	θ_U		--	80	--	
		θ_D		--	80	--	

REV	REVISION RECORD	DATE	APPROVED	NAME

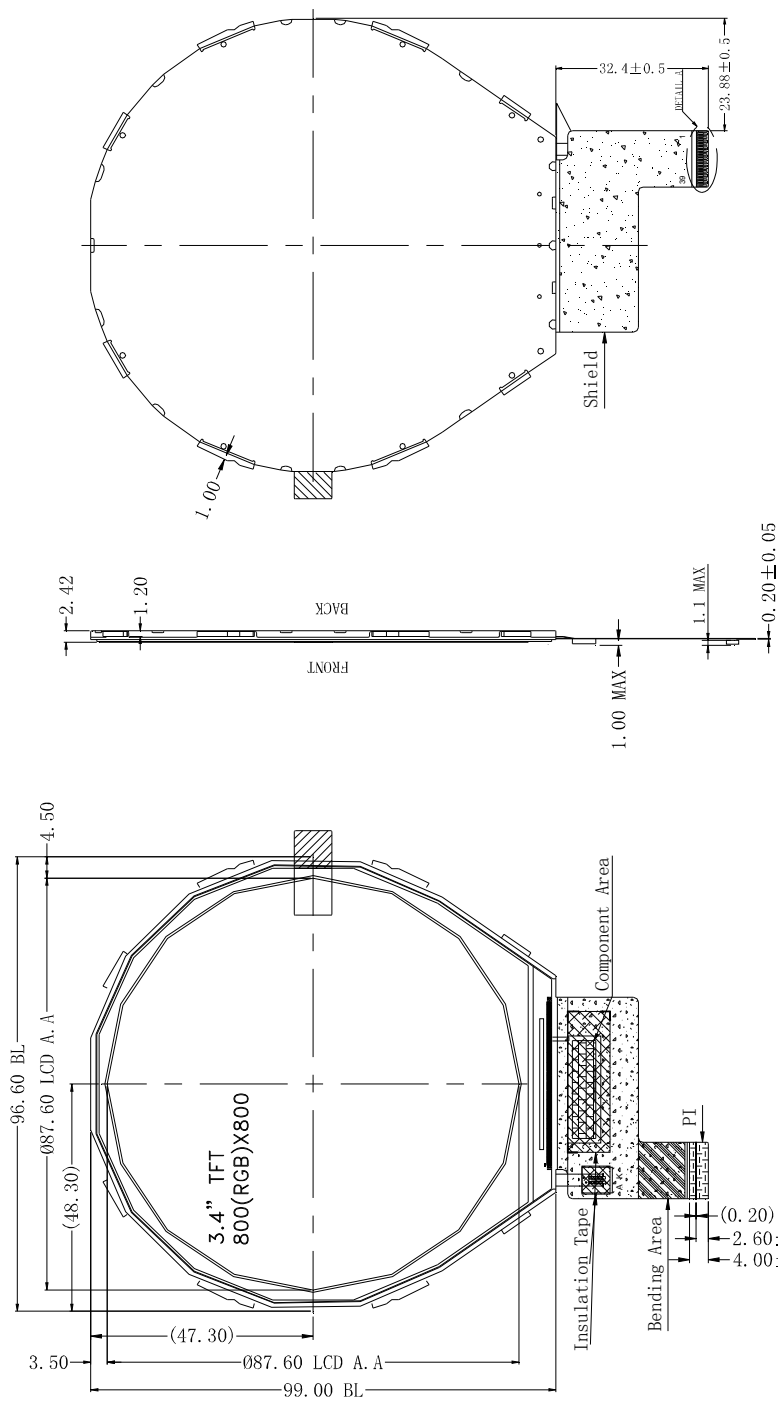

TOLERANCE	MATERIAL	FINISH	MODEL NAME
			KH1909006 (3.4" 800x800)
VERSION	SCALE	NO.	UNIT
A	1/1	1/1	mm
DATE	APPROVED	CHECKED	DRAWN
2019.09.23			Kevin
FILE NAME			

